

Ultrasonic Dog Repeller



MODEL: PU50

Preface

Hi! I am a user manual, let me tell you how to use PU50 ultrasonic dog repeller correctly.

PU50 ultrasonic dog repeller, which uses the principle of ultrasound to emit sound waves to interfere with the dog, so that it will feel stimulated and stops the current behavior. For example, you can expel a dog who is coming to you, or you can let the dog stop barking.

PU50 uses a frequency of 22-25KHZ, which is difficult for human hearing to perceive, but it is the most sensitive frequency for dogs. But the sound will not negatively affect the dog's hearing or health, it is an effective and safe product!

Ultrasonic Bark Control

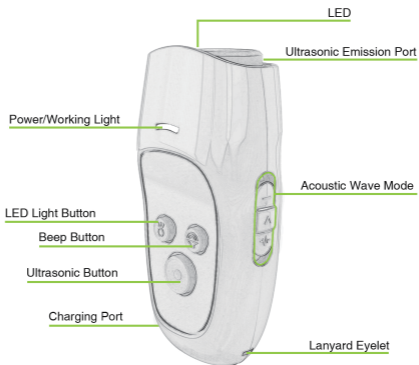

Packing List:

Dog Bark Control Device*1	USB Cable*1	
Wrist Strap*1	Whistle*1	Lanyard*1
Clicker *1	Instruction Manual*1	

Product function

1. Usage of Ultrasonic

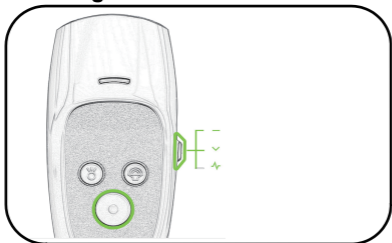

- The side push button has three different sound wave modes, which are initiated by 22-25KHZ
 - Stable and continuous sound waves
 - ✓ Undulating Sound waves
 - ⚡ Sound waves with irregular frequencies
- After selecting the sound wave mode, please press the launch button, it will directly to send out ultrasonic waves.
- The animal's hearing will become immune to a certain sound after a long time of adaptation, so multiple sound waves can break the dog's immunity to a certain sound

wave. It can extend the effective usability of the product, so you can use different sound waves alternately in each period of time.

- The working distance of PU30 ultrasonic dog repeller is 5 meters, which is better for indoor use.

2. Usage of warning tone

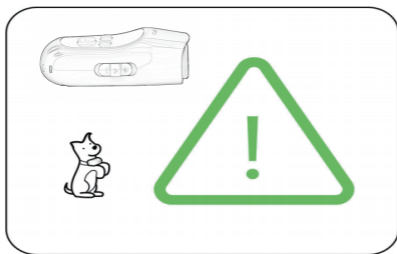

- BEEP sound, you can use it before each use of ultrasound, so that some dogs can be conditioned to reflect, and they will react after hearing the BEEP sound.
- The BEEP mode can combine into your usual dog training instructions. For example, when press BEEP button to call your dog every time , and then you can give a reward. After multiple uses, the BEEP sound will

become the sound of calling the dog.

3. LED mode

- Click the LED button, this can turn on your LED light, which can be used for lighting when you walk your dog outdoors at night
- Long press the LED button without releasing it, it will flash quickly, can be used as a reminder and warning to the dog, and can be used with ultrasound.

4. Indicator Light

- When the play button is pressed, the green light indicates that the product is working effectively.
- When the item is less than 15% power, the red light will flash.

Battery

1. When the device shows low power, please charge it as soon as possible.
2. After fully charged, please remove the power supply as soon as possible to avoid prolonged charging.

3. When the battery is damaged, do not repair or disassemble it.
4. Charging time is about 2 hours.
5. Do not use adapters larger than 5V2A to charge the product.
6. This product uses 300 mAh battery.
7. Do not immerse the product in water or extreme environments (below 0 °C or above 45 °C). Extreme environments may shorten the service life of the product.

Notice

- 1 Use of this product means you accept all the terms and conditions.
- 2 This product cannot be applied to dogs with strong anti-defense, and has no effect on older or hearing-impaired dogs.
- 3 Different dogs may have different responses to sound waves. For best results, you can use this product with other training tools and instructions together.
- 4 This product is a professional dog training device

and cannot be used for other purposes. Please do not violate local laws in using this product.

5. We are not responsible for any direct or indirect damages caused by use or misuse of this product, all risks in using this product are the responsibility of the user.

6. Please contact the dealer for parts service, goods return or exchange. We provide technical support only.